



INTRODUCTION

The USER MANUAL **Mapache Extinguishing Backpack** has been designed to be a portable and effective solution for firefighting in emergency situations. With an ergonomic design and high water-carrying capacity, this equipment is ideal for forest brigades, rescue personnel, and users who need to control fires quickly in challenging environments.

This manual aims to guide the user step by step in the proper use of the equipment, ensuring safety and efficiency.

General Warnings

This equipment must be used exclusively by trained personnel or under the supervision of someone experienced in firefighting.

Before using the equipment, ensure that all parts are correctly assembled.

Never use the extinguishing backpack in fires involving hazardous chemicals or flammable liquids.

Avoid exposing the backpack to extreme temperatures or heat sources that may compromise its integrity.

COMPONENTS

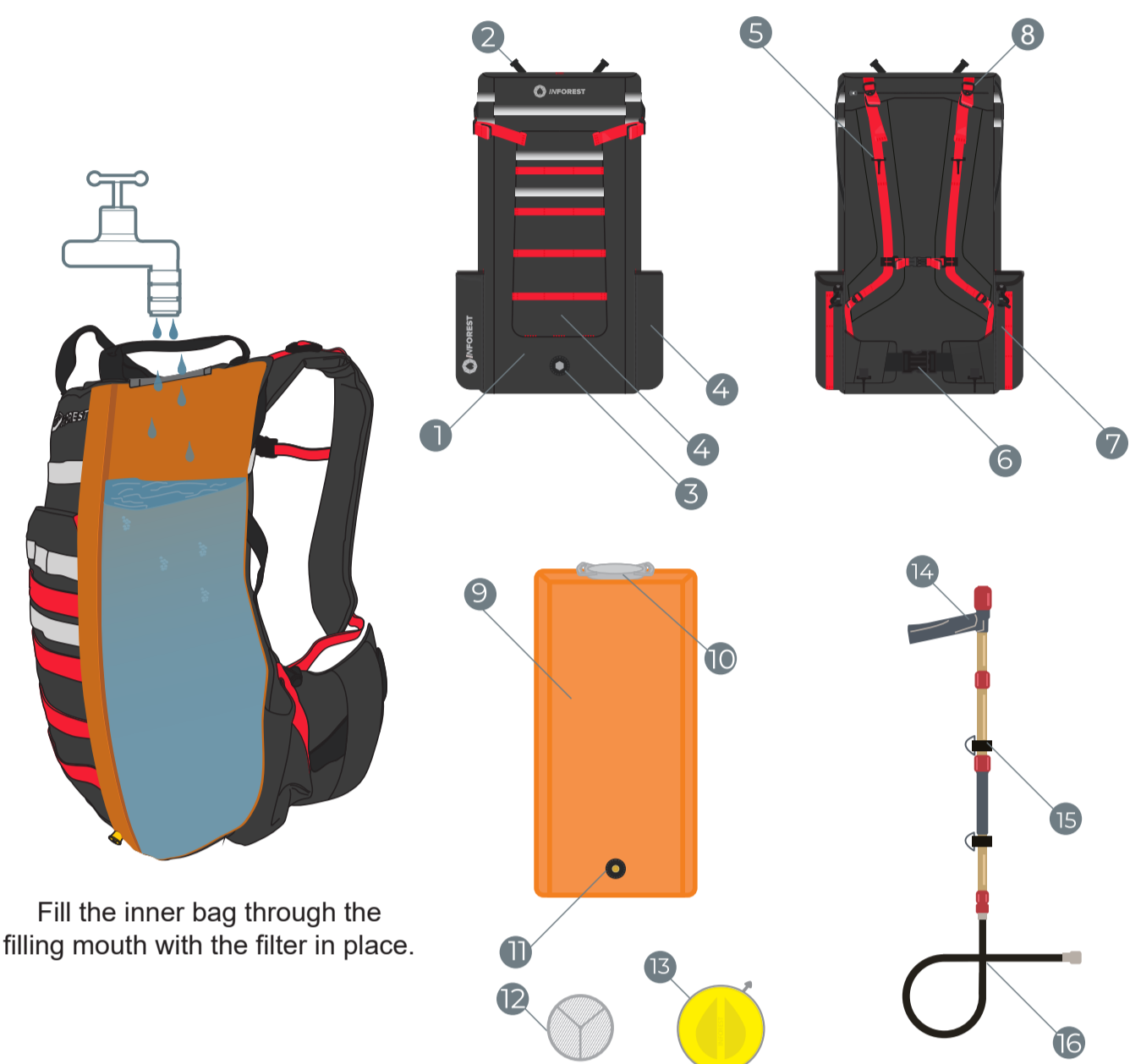

Fill the inner bag through the filling mouth with the filter in place.

N°	COMPONENTS
1	Mapache Extinguishing Backpack
2	Handles
3	Washer for fastening coupling
4	Pocket
5	Snap hook buckle 30 mm
6	Fastening buckle 50 mm with adjuster
7	Bottle-carrying pocket
8	Buckle for lumbar adjustment
9	Inner bag for water backpack
10	PVC filling mouth
11	Quick coupling for discharge valve
12	Reinforcing washer with filter mouth
13	Lid for water backpack
14	Double-effect nozzle
15	Nozzle holder
16	Backpack discharge hose

MODE OF USE

The correct use of the Mapache Extinguishing Backpack is crucial to ensure its effectiveness in emergency situations. The steps to follow for its preparation, operation, and maintenance are described below.

INNER BAG REMOVAL

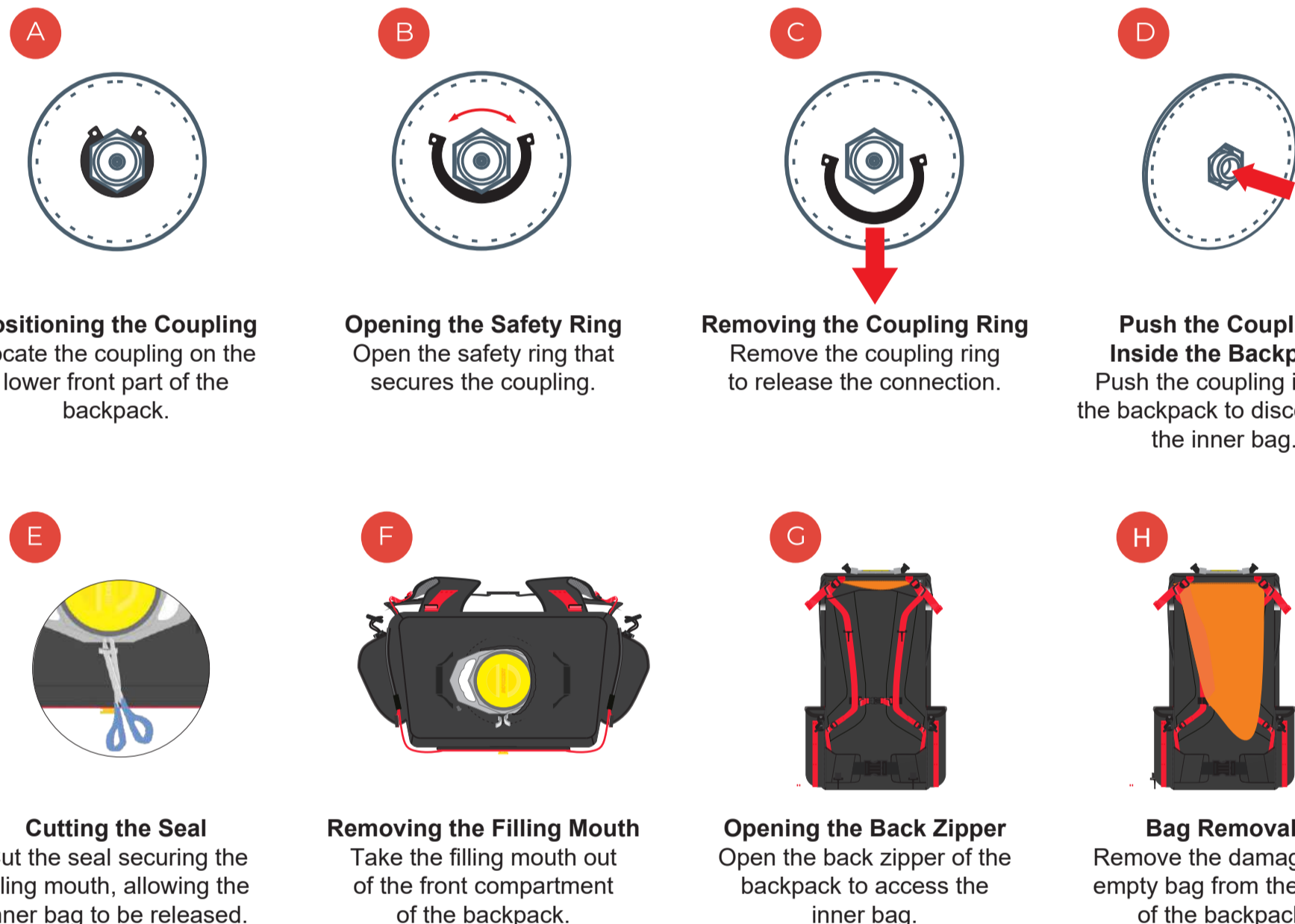

Positioning the Coupling
Locate the coupling on the lower front part of the backpack.

Opening the Safety Ring
Open the safety ring that secures the coupling.

Removing the Coupling Ring
Remove the coupling ring to release the connection.

Push the Coupling Inside the Backpack
Push the coupling inside the backpack to disconnect the inner bag.

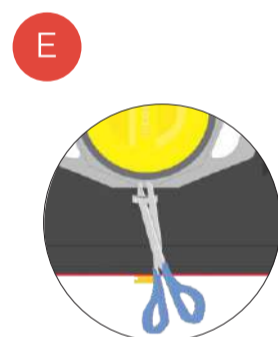

Cutting the Seal
Cut the seal securing the filling mouth, allowing the inner bag to be released.

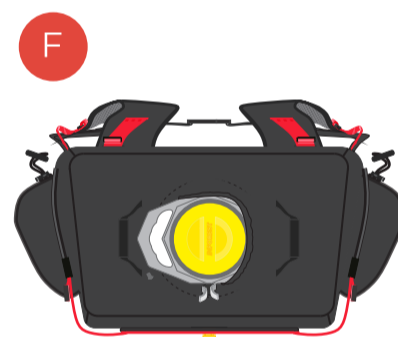

Removing the Filling Mouth
Take the filling mouth out of the front compartment of the backpack.



Opening the Back Zipper
Open the back zipper of the backpack to access the inner bag.



Bag Removal
Remove the damaged or empty bag from the back of the backpack.

ASSEMBLY OF THE MAPACHE BACKPACK



Opening the Back Pocket
Open the back pocket of the backpack.

Inserting the Inner Bag
Insert the inner bag through the back zipper. Ensure that the bag is correctly aligned within the compartment.

Securing the Filling Mouth
Attach the filling mouth into the upper cavity of the backpack. Use the seal to secure it and prevent it from coming loose.

Inserting the Coupling into the Washer
Insert the male coupling into the washer. Confirm proper placement before proceeding to the next step.

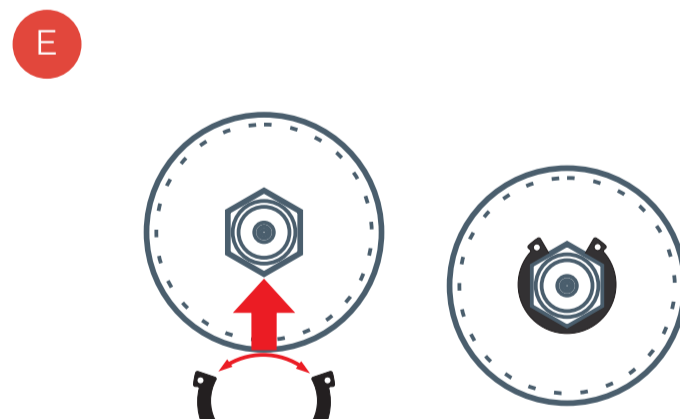

Placing the Safety Ring
Open the safety ring and place it in the coupling slot to secure it.

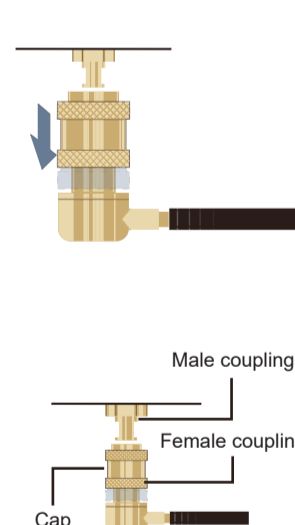

Removing the Cap
Remove the cap from the female coupling on the hose. Ensure the cap is fully retracted to allow proper coupling.

Connecting the Hose
Connect the female coupling of the hose to the male coupling on the backpack as shown in the image.



Verification
Tighten both couplings securely to prevent water leaks during use. Check for any leaks before using the backpack.

WASHING INSTRUCTIONS

- Remove the hose, nozzle, and inner bag following the same procedure described in the Inner bag removal instructions in this manual.
- Disassemble the cap from the textile strap by loosening the stainless steel Phillips screw and remove the cap along with the washer.
- Hand wash the backpack or machine wash it, always avoiding spinning to prevent damage to the components.
- Ensure you only wash the textile part of the backpack to keep all sewn components intact.
- Let the backpack air dry in the shade after washing to preserve the integrity of the materials.
- Once clean and dry, reattach the cap to the textile strap and tighten the Phillips screw with the washer.
- Reinsert the inner bag.
- Position the reinforcing washer with the filter in the correct position.
- Finally, screw on the hose and nozzle, ensuring a tight fit.

MAINTENANCE AND CARE

- After each use, empty the inner bag completely and rinse it with clean water.
- Inspect the buckles, washers, and couplings periodically for signs of wear or damage.
- Store the backpack in a dry place, protected from direct sunlight.



WARRANTY

- To ensure maximum durability and prevent damage, it is essential to follow the product's usage and care instructions.
- Improper use of the Mapache Backpack or cleaning processes not indicated in this manual may compromise its durability and performance.
- Inforest SRL offers a one-year warranty for manufacturing defects. However, it will not be liable for incidental or indirect damages resulting from incorrect use or unauthorized modifications.



INFOREST ARGENTINA
WWW.INFOREST.COM.AR
ventas@inforest.com.ar
comex@inforest.com.ar

Instagram: inforest_incendiosforestales
Facebook: inforest.cba

Brasil 1238 Alta Gracia
Córdoba - Argentina CP: 5186
Tel/Fax: +54 (0)3547- 430529 | 406693
CUIT 33-71411717-9

INFOREST IBÉRICA
WWW.INFORESTIBERICA.COM
info@inforestiberica.com

Instagram: inforestiberica
Facebook: inforestibericaSL

C Estación 32, Campo Real
Madrid España
Tel: +34 681 31 46 46